

How to register, sync, login and create an Apostrophy Account

How to register, sync, login and create an Apostrophy Account

1. Ensure you have an internet connection (SIM data or WLAN).
2. Open 'My Account' app on the home screen if skipped during the first time set up.
3. If you already have an Apostrophy account:
 - a. Sign in by entering your aphy email address and password.
 - b. Tap SIGN IN.
4. Tap SYNC ACCOUNT at bottom of screen.
5. Tap LOGIN at bottom of screen.
6. Tap CREATE ACCOUNT at bottom of screen.
7. Your account is ready to go.
8. Close 'My account' app.

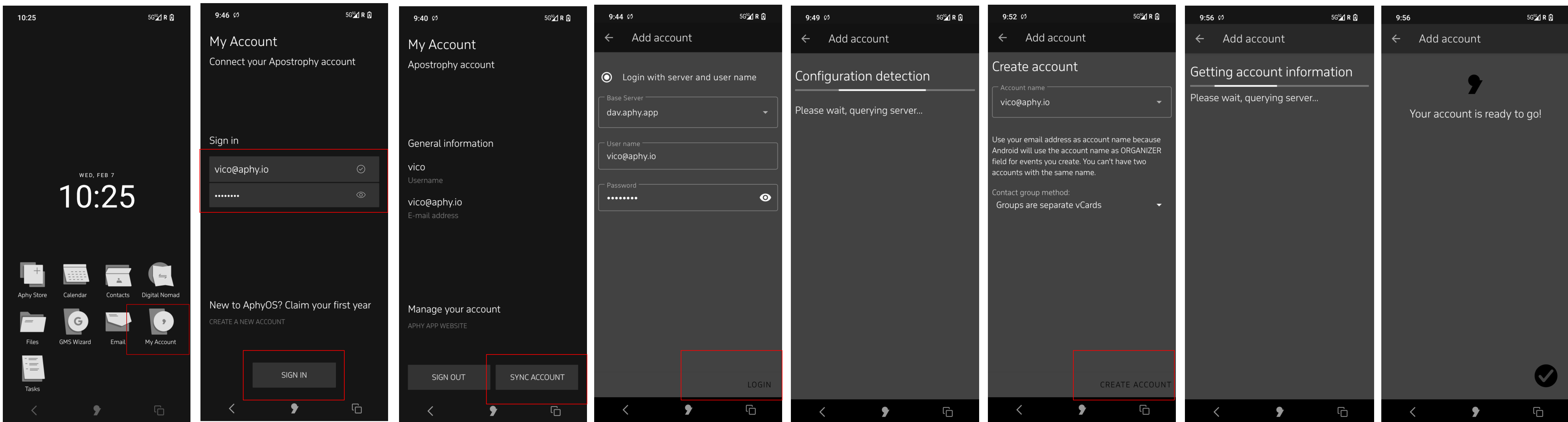

Error messages

1. If during sign in an incorrect email or password is entered.
“Connection failed. Please check account info”.

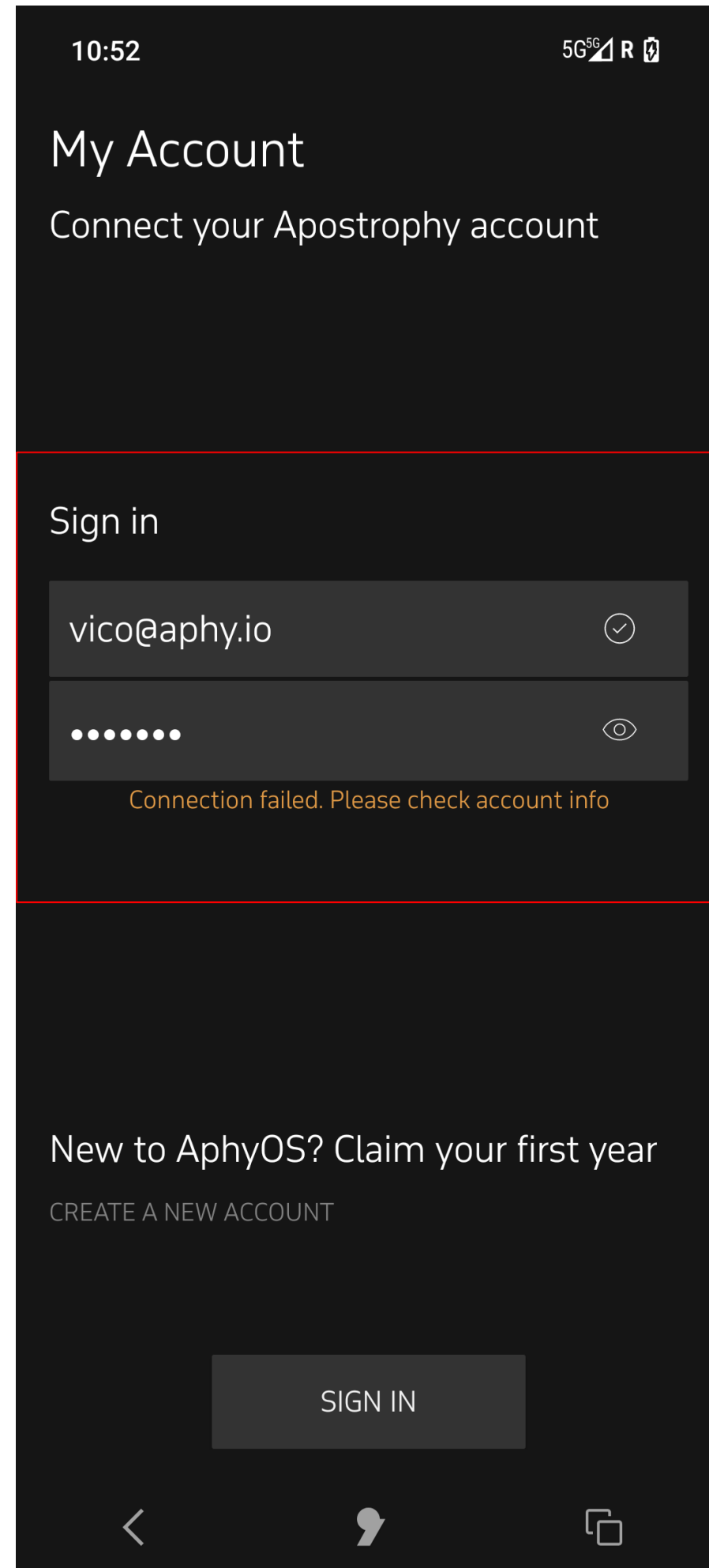

2. When creating account, if the email name chosen is already in use.
“Connection failed. Please check account info”.

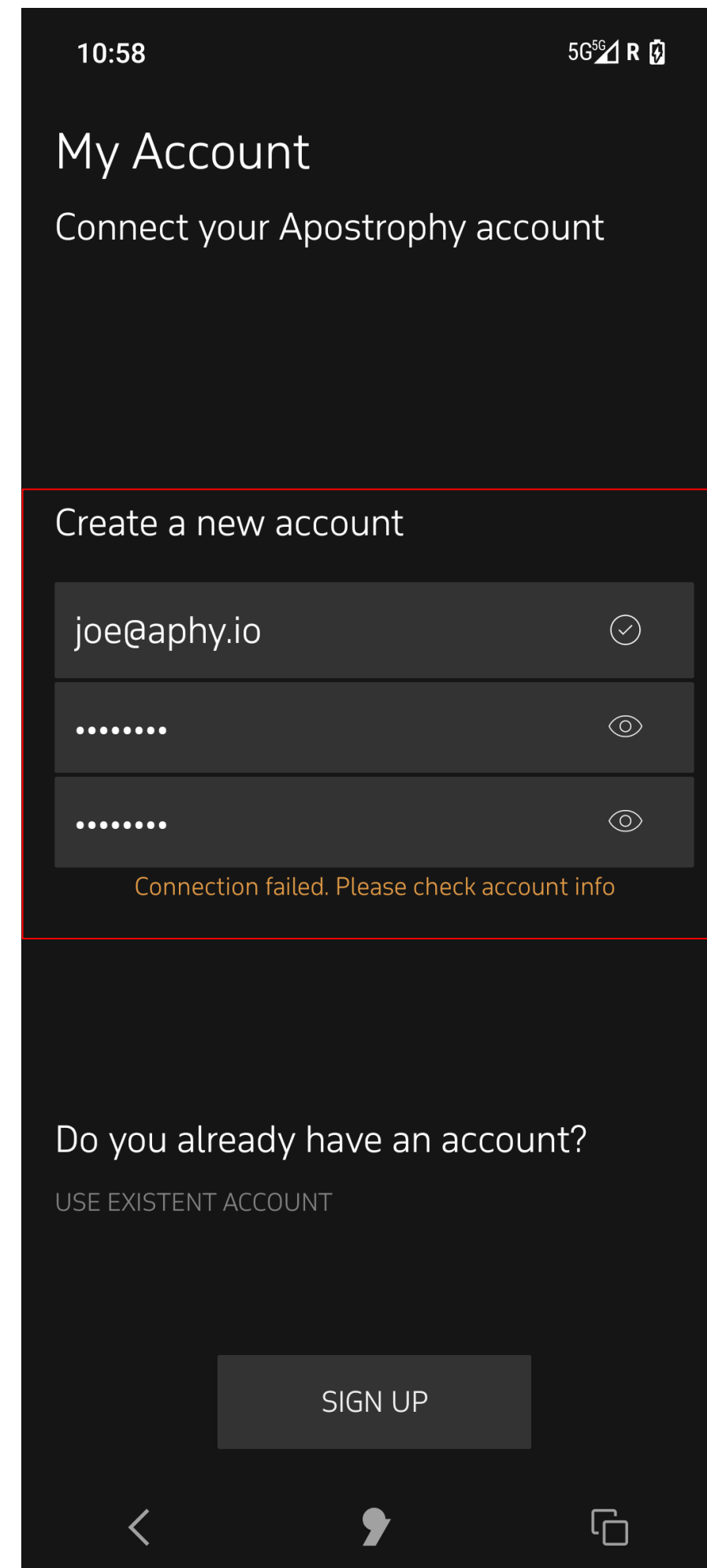

3. No internet connection
“No network connection”

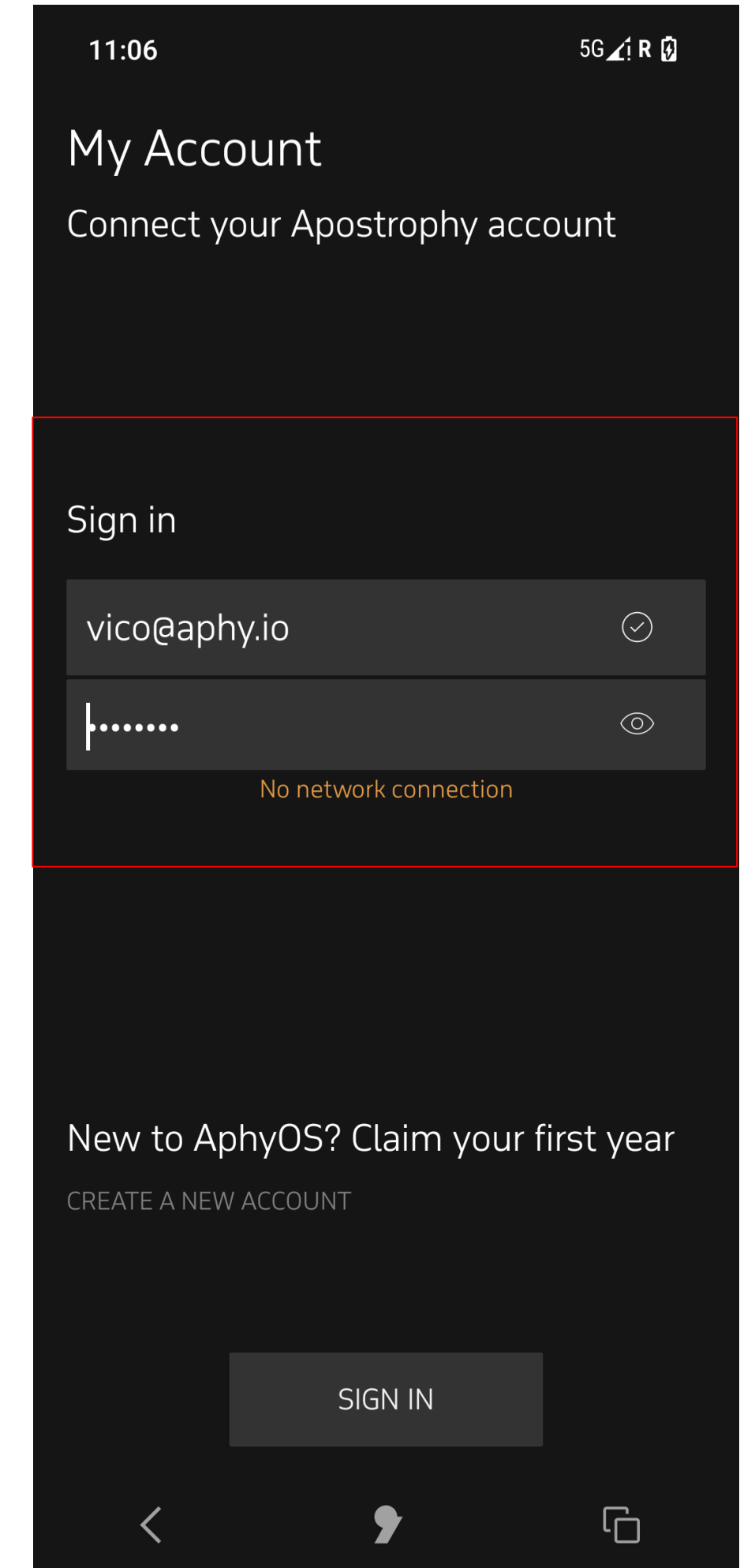

punkt.ch
info@punkt.ch

Tel +41 91 924 9003
Fax +41 91 924 9004

Punkt Tronics AG
Via Losanna 4
CH-6901 Lugano
Switzerland

Punkt.